

# TOUCHLESS POUR *CUP FIRST, THEN HAND*

**STEP 1**

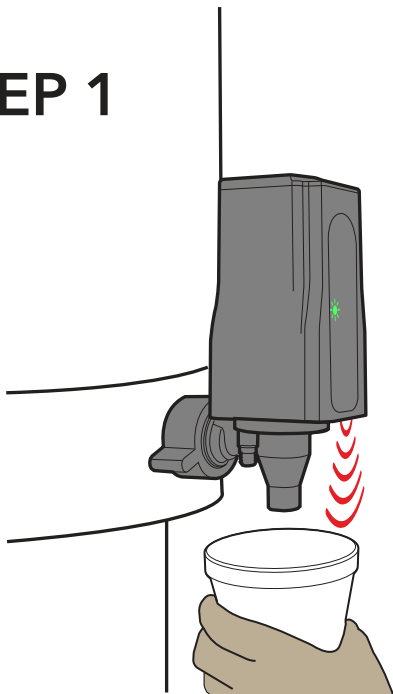

**STEP 2**

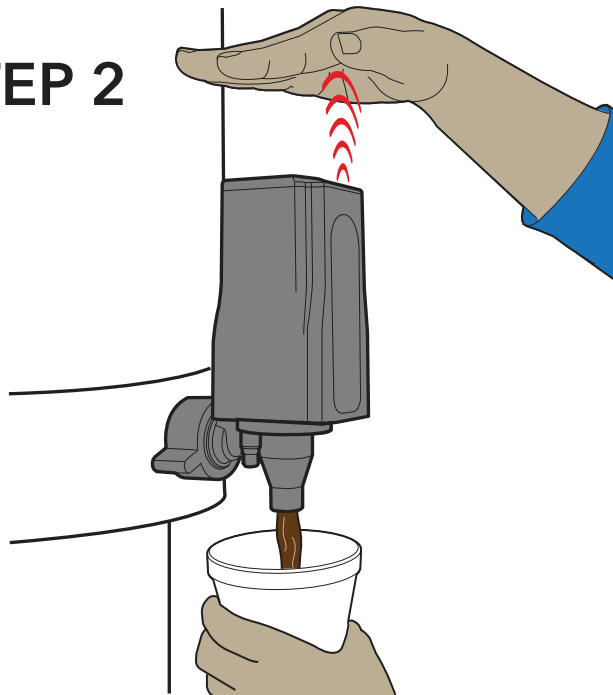

# TOUCHLESS POUR *CUP FIRST, THEN HAND*

**STEP 1**

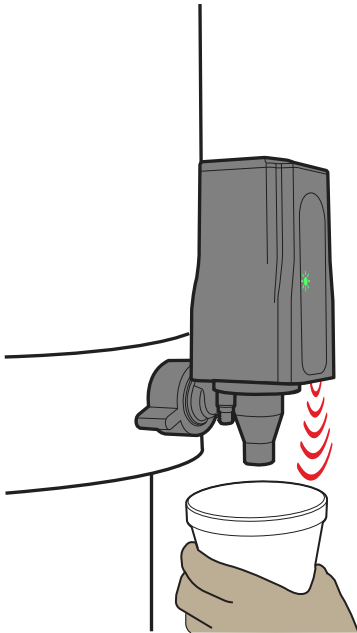

**STEP 2**

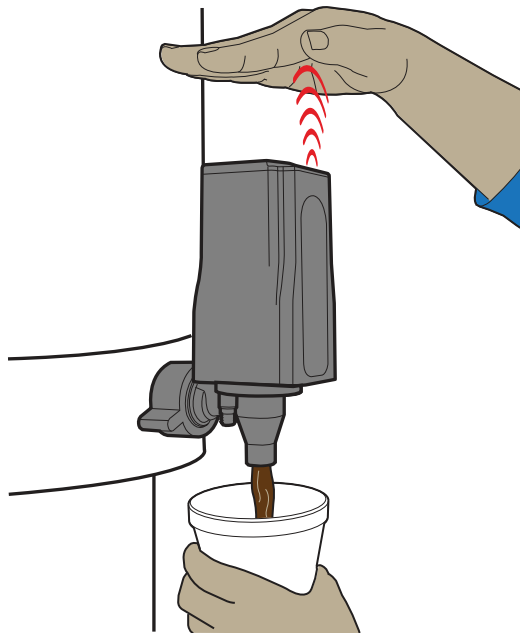

---

**Hold cup below the valve**

 *Green LED will flash*

**Put your hand above the top sensor**